

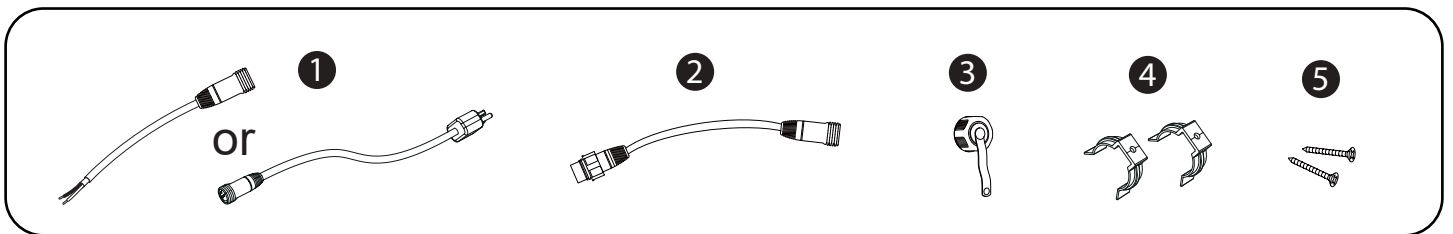

## Horti-Tube Accessories



- 1 Power Cable(Standard without Plug) or Optional power cable with plug
- 2 50cm (1.6ft) Jumper Cable (Optional)
- 3 End-Cap
- 4 Mounting Clips
- 5 Self-tapping Screws

## Single Horti-Tube Installation

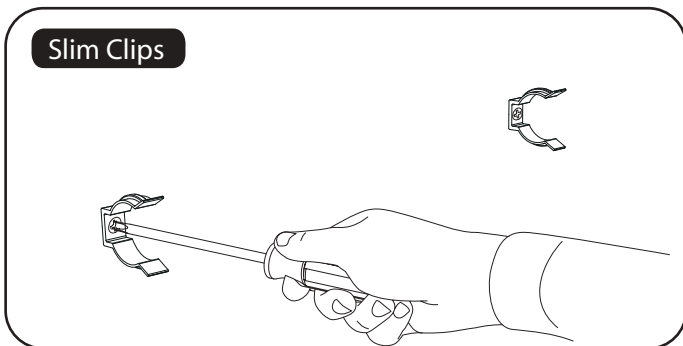

1. Mounting each clip on the wall or ceiling by using two Self-Tapping Screws.

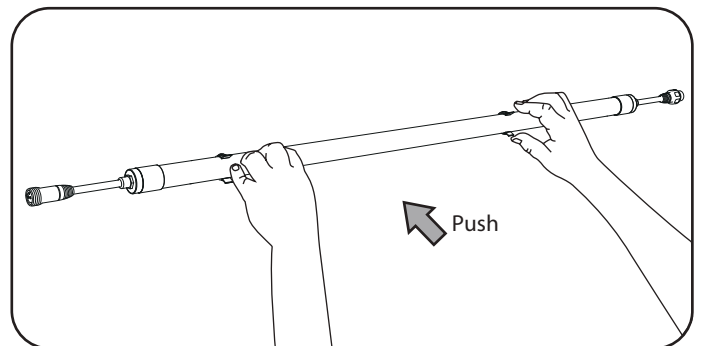

2. Pressing the Horti-Tube into the Clips.

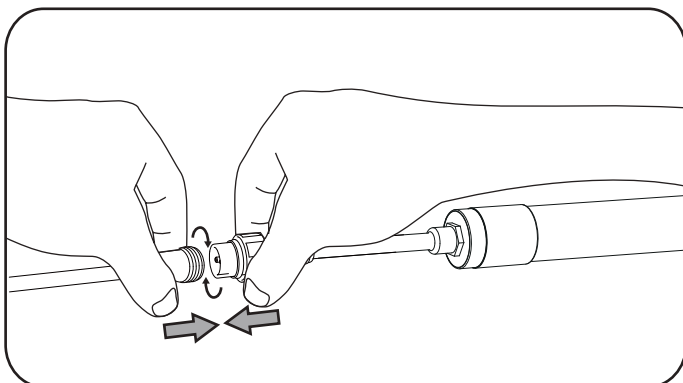

3. Connect the Power Cable to Male Connector of the Horti-Tube. And Twist the Cap.

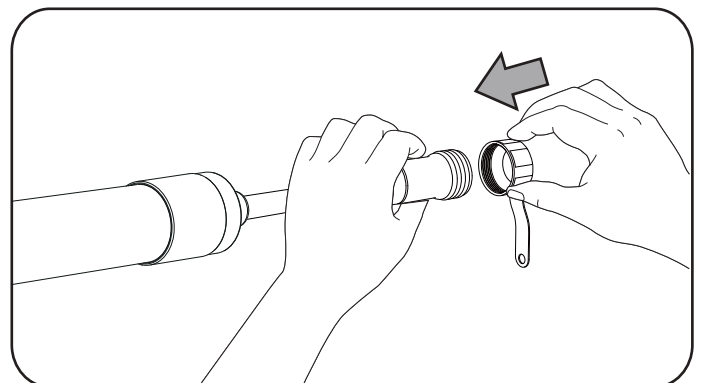

4. Twist the End-cap on the Female Connector.

## Multiple Horti-Tube Installation

### 1. Installation Method (Round)

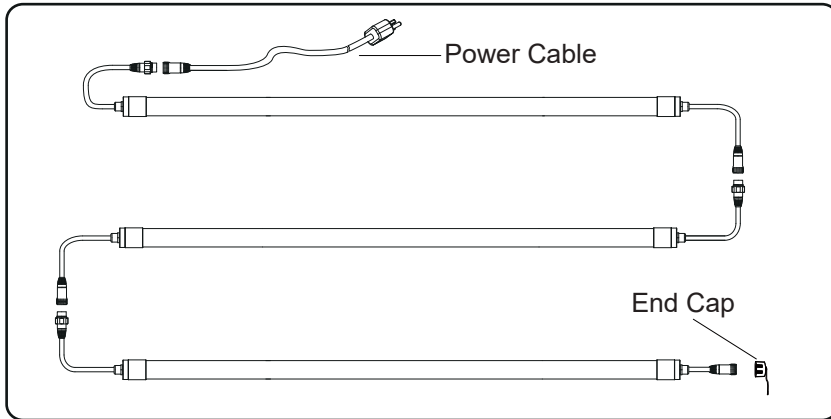

**⚠ For Maximum Number of Tubes Connection per Power Cable. Please refer to Multiple Tube Connection Detail.**

### 2. Installation Method (Linear)

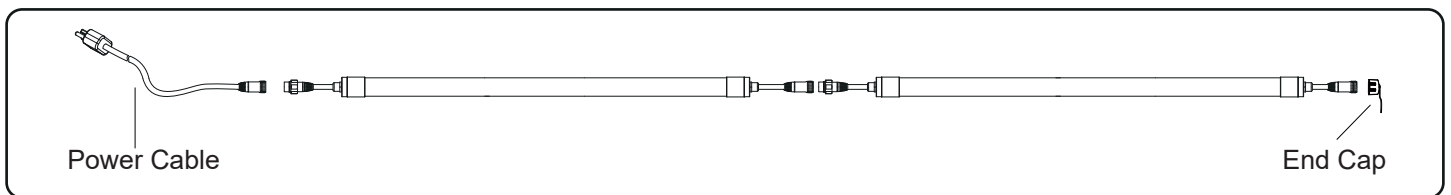

## Multiple Layers Installation

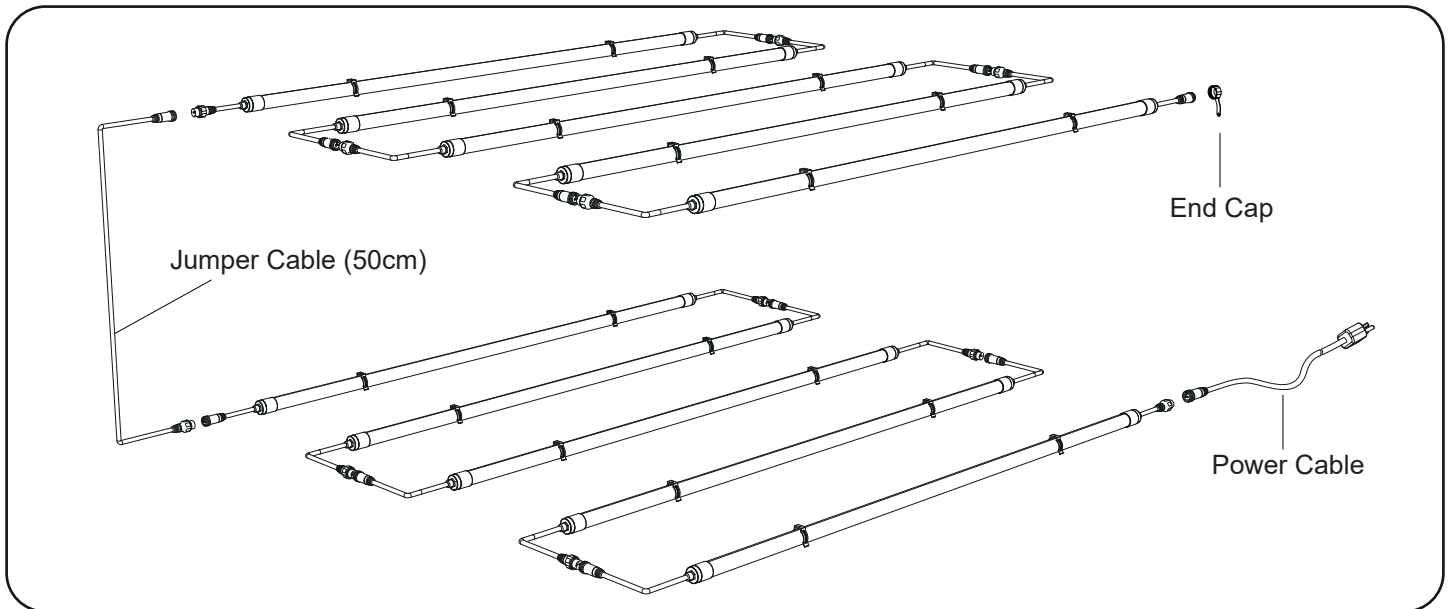

## Multiple Tube Connection Detail

Input Voltage: 85Vac – 265Vac, 50/60Hz

Product Name	Length	Power	Maximum Tube Per Power Cable	
			120 Vac	240 Vac
Horti -Tube 11W	0.6M(2ft)	11watt	25	50
Horti -Tube 22W	1.2M(4ft)	22watt	15	30
Horti -Tube 28W	1.5M(5ft)	28watt	12	22